

		PART NUMBERS	A	B	∅ min.	∅ max.
16A	2P+⊕	PEW 16x3 PV	145	77	7	16
	3P+⊕	PEW 16x4 PV	145	85	7	16
	3P+N+⊕	PEW 16x5 PV	145	93	8	24
32A	2P+⊕	PEW 32x3 PV	162	97	8	24
	3P+⊕	PEW 32x4 PV	162	97	8	24
	3P+N+⊕	PEW 32x5 PV	162	105	8	24

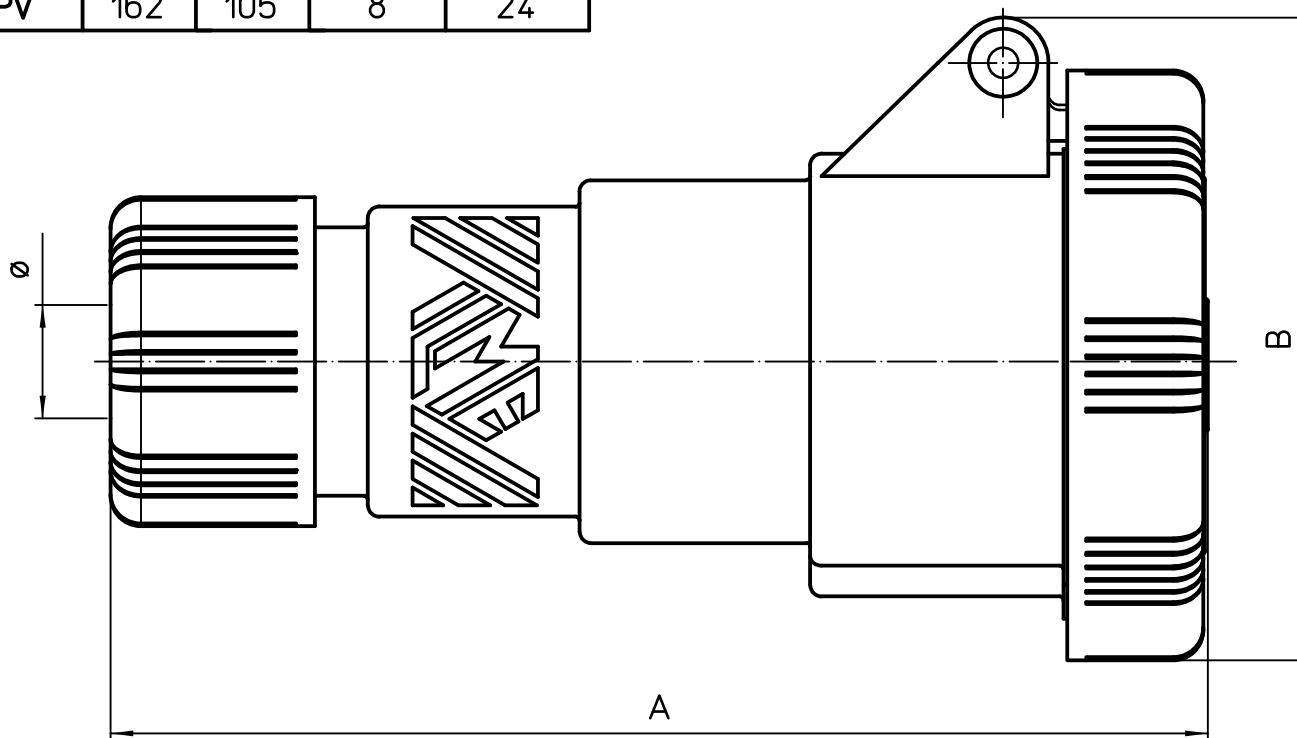

dimensions in mm		PEW PV		Scale	
Date 05/03/10		socket 16/32A			
Sign. Visentin				